

- 1 PROPOSED ADOPTED SW HIGHWAY DRAINAGE OUTFALL
- 2 PROPOSED FOUL DRAINAGE CONNECTION FROM EXISTING DIVERTED FOUL IN OAKWOOD DRIVE, ALLOWANCE FOR CONNECTIONS SERVING FUTURE RESIDENTIAL, COMMERCIAL AND RETAIL UNITS
- 3 ASSUMED EXISTING ROUTE OF ADIT DRAIN
- 4 PROPOSED FUTURE SW OUTFALLS FROM RESIDENTIAL, COMMERCIAL AND RETAIL UNITS
- 5 EXISTING SW HIGHWAY DRAINAGE TO REMAIN - NOMINAL EASEMENT, PARTIAL STERILISATION OF LAND ASSOCIATED WITH TRANSPORT EXCHANGE AREA
- 6 WITH REF. TO 2, EXISTING FOUL OR COMBINED SEWER FROM OAKWOOD DRIVE TO BE DIVERTED TO NORTH EAST DCWW 600mm COMBINE SEWER
- 7 WITH REF. TO 2, EXISTING FOUL OR COMBINED SEWER FROM OAKWOOD DRIVE TO BE DIVERTED TO NORTH EAST DCWW 600mm COMBINE SEWER, POSSIBLE OLD CSO CHAMBER, FURTHER INVESTIGATION REQUIRED
- 8 CONTRIBUTING AREA OF HIGHWAY DRAINAGE DISCHARGING TO POINT 1
- 9 EXISTING DCWW COMBINED SEWER TO BE ABANDONED FOLLOWING DIVERSION DISCUSSED IN POINT 2
- 10 FUTURE FOUL CONNECTION FROM RESIDENTIAL DEVELOPMENT
- 11 PROPOSED CIRCA 8m DEEP ADIT DRAIN (OPEN CUT)
- 12 WITH REF. TO 9, LAST DCWW COMBINED CHAMBER TO REMAIN TO ACCOMMODATE FUTURE FOUL CONNECTION FROM RESIDENTIAL AREA AND FOUL CONNECTION
- 13 FOUL CONNECTION FROM INDUSTRIAL DEVELOPMENT DISCHARGING TO POINT 12
- 14 DOMESTIC SW CONNECTION FROM RESIDENTIAL DEVELOPMENT DISCHARGING TO POINT 15
- 15 EXISTING HEADWALL SUBMERGED, PROPOSALS TO REPLACE HEADWALL
- 16 ADIT DRAIN TO CONNECT TO EXISTING SWS, POSSIBLE REPLACEMENT REQUIRED DOWNSTREAM TO POINT 15 SUBJECT TO CAPACITY AND CONDITION
- 17 BCBC SW HIGHWAY DRAINAGE TO BE ABANDONED UPSTREAM OF POINT 16 AND DIVERTED THROUGH DEVELOPMENT AND DISCHARGE AT POINT 1
- 18 PROPOSED DIVERTED HIGHWAY DRAINAGE TO COMMUNICATE WITH PROPOSED ADIT DRAIN
- 19 SW DRAINAGE FROM WEST SIDE OF OAKWOOD DRIVE, QUANTITY OF SW CONTRIBUTION UNKNOWN

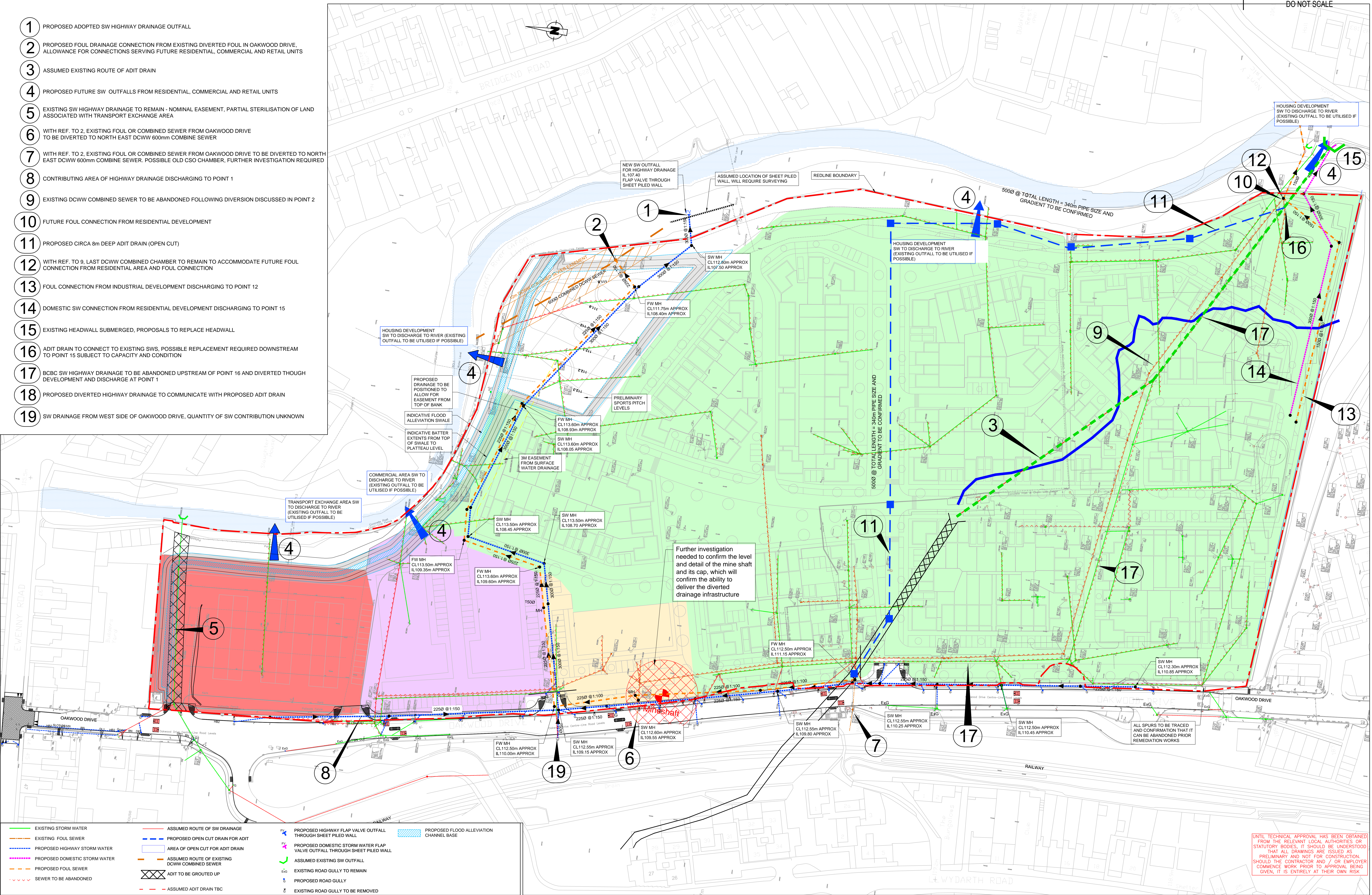

<ul style="list-style-type: none"> <li>— EXISTING STORM WATER</li> <li>— EXISTING FOUL SEWER</li> <li>— PROPOSED HIGHWAY STORM WATER</li> <li>— PROPOSED DOMESTIC STORM WATER</li> <li>— PROPOSED FOUL SEWER</li> <li>— SEWER TO BE ABANDONED</li> </ul>	<ul style="list-style-type: none"> <li>— ASSUMED ROUTE OF SW DRAINAGE</li> <li>— PROPOSED OPEN CUT DRAIN FOR ADIT</li> <li>— AREA OF OPEN CUT FOR ADIT DRAIN</li> <li>— ASSUMED ROUTE OF EXISTING DCWW COMBINED SEWER</li> <li>— ADIT TO BE GROUTED UP</li> <li>— ASSUMED ADIT DRAIN TBC</li> </ul>	<ul style="list-style-type: none"> <li>— PROPOSED HIGHWAY FLAP VALVE OUTFALL THROUGH SHEET PILED WALL</li> <li>— PROPOSED DOMESTIC STORM WATER FLAP VALVE OUTFALL THROUGH SHEET PILED WALL</li> <li>— ASSUMED EXISTING SW OUTFALL</li> <li>— EXISTING ROAD GULLY TO REMAIN</li> <li>— PROPOSED ROAD GULLY</li> <li>— EXISTING ROAD GULLY TO BE REMOVED</li> </ul>	<ul style="list-style-type: none"> <li>— PROPOSED FLOOD ALLEVIATION CHANNEL BASE</li> </ul>
--	---	---	---

NOTES  
 1. ALL DIMENSIONS IN METERS  
 2. PROPOSED PIPE SIZES AND GRADIENTS SHOWN ARE INDICATIVE ONLY AND TO BE CONFIRMED DURING DETAIL DESIGN  
 3. ADDITIONAL SURVEYING MAY BE REQUIRED TO CONFIRM EXISTING DRAINAGE FEATURES WHERE ORIGINAL SURVEYING TRACES WERE ABANDONED  
 4. NO PROPOSED WORKS OR ABANDONMENT ARE TO BE CARRIED OUT ON EXISTING DRAINAGE FEATURES BEFORE CONFIRMATION OF WHAT IS CURRENTLY UTILISING THE NETWORK

5. LANDSCAPED AREAS WITHIN THE DEVELOPMENT PROPOSALS WILL PROVIDE A BETTERMENT TO THE EXISTING CONTRIBUTING AREAS AS CURRENT BROWNFIELD DEVELOPMENT IS MOSTLY HARDSTANDING

KEY

■ TRANSPORT EXCHANGE	■ RETAIL AND APARTMENTS
■ COMMERCIAL AREA	■ RESIDENTIAL

REV	DATE	BY	DESCRIPTION	CHK	APP
P04	07/11/2022	ADW	SOUTHERN MOST ACCESS REMOVED IN LINE WITH UPDATED MASTERPLAN	AW	AW
P03	17/08/2022	ADW	ALLEVIATION CHANNEL UPDATED, NEW MASTERPLAN UNDERLAD	AW	AW

OWNERS/STATE: S2 - FOR INFORMATION

1 Capital Quarter  
 Tyndall St  
 Cardiff  
 CF10 4BE, UK

T +44 (0) 292 076 9200  
 wsp.com

PROJECT: PONTARDAWE COAL & METALS LTD

CLIENT: POWELL DOBSONS ARCHITECTS

PROJECT: EWENNY ROAD, MAESTEG

FILE: DRAINAGE STRATEGY

SCALE: 1:500	DESIGNER: ADW	APPROVED:
PROJECT: 70060546	DESIGNED: DRC	DATE: November 22
DRAWING: 70060546-WSP-XX-XX-DR-0003	REV: P04	

UNTIL TECHNICAL APPROVAL HAS BEEN OBTAINED FROM THE RELEVANT LOCAL AUTHORITIES OR STATUTORY BODIES, IT SHOULD BE UNDERSTOOD THAT ALL DRAWINGS ARE ISSUED AS PRELIMINARY AND NOT FOR CONSTRUCTION. SHOULD THE CONTRACTOR AND / OR EMPLOYER COMMENCE WORK PRIOR TO APPROVAL BEING GIVEN, IT IS ENTIRELY AT THEIR OWN RISK.

© WSP UK Ltd